

# Electronic Sighting Device Instruction Manual

## SIGHTRON™

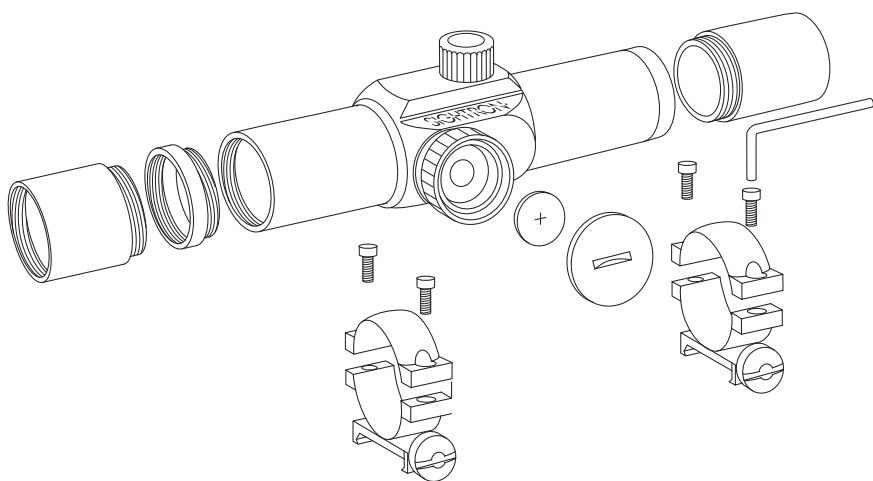

### Using Your Scope

**Caution:** Always use eye and hearing protection and follow proper safety rules when handling or firing a gun. Always insure your weapon is unloaded when mounting or replacing batteries in your sight.

1. Using a penny, remove the battery cap by holding the knurled rheostat ring and turn the battery cap counter clock-wise. Install the battery with the (+) up and re-tighten the cap.

Note: Do not over tighten cap, as only a snug fit is required for proper operation.

2. Turn the rheostat switch to the desired setting. The higher the selection. The brighter the illuminated dot will appear. It is recommended you use the lowest possible setting to reduce glare and create a better defined dot. Lighting conditions will usually determine the lowest settings possible.

3. Your new scope is equipped with a front extension tube. This tube can be used to create a longer mounting area or to reduce unwanted glare caused by the sun or other lighting sources.

4. To switch reticle patterns on the S33-4R locate the reticle turn switch on the left side of the ESD. By turning the knob you can select different reticle options to fit your shooting needs.

5. Night Vision 1 (NV1) and (NV 2) settings are offered on the S33-MIL for use with night vision. This switch is located on the 8 position intensity switch.

### Mounting Your Scope

**Caution:** Always use eye and hearing protection and follow proper safety rules when handling or firing a gun. Always insure your weapon is unloaded when mounting or replacing batteries in your sight.

Note: Never use your scope as a lever to twist rings into proper placement - certain damage will occur

1. Using your allen wrench, remove hex screws top caps on both rings.

2. Mount both bottom halves of rings on your Weaver-type base and lighten slightly.

3. After you have determined proper spacing and eye relief, place your scope into the mount bottom halves and center the scope. The elevation adjustment knob should be directly in alignment with the bore axis of the gun. Your scope should be mounted.

### Sighting In Your Gun

**Caution:** Always use eye and hearing protection and follow proper safety rules when handling or firing a gun. Always insure your weapon is unloaded when mounting or replacing batteries in your sight.

1. It is highly recommended that you have your new scope collimated by a qualified gunsmith before heading to the range.

2. Your new scope has been optically centered at the factory and superior performance will be obtained with minimal adjustments.

3. If you are unable to obtain the services of a qualified gunsmith or do not have access to a collimator, the following procedure will be highly effective and efficient.

a. Place a 2 to 3 foot square target at a distance of 15 to 25 yards. Draw or place a 1" square in the center.

b. Using a steady rest, fire one shot at the center of the bulls eye. Return the gun to the exact position and adjust the reticle to the point of impact of the first bullet. At this point, fire one more shot at the bulls eye. This shot should be within one inch of your target. Make final adjustments as necessary with the next shot.

First Shot

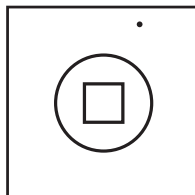

First Adjustment

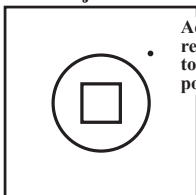

Adjust reticle to this point

## S30-5

The S30-5 is equipped with an 11 position rheostat to adjust for varying light conditions. Higher settings are for use on bright days when contrast can be low the lower settings provide dimmer light when shooting in low light conditions or dark backgrounds.

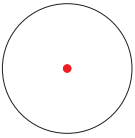

S30-5 5 MOA Dot Reticle

## S33-4R/RST

The S33-4R and 4RST offer four reticle patterns for use in a wide variety of hunting and shooting situations. For target use on your favorite handgun to turkey hunting with your favorite shotgun a pattern is available for every

need. The Sightron S33-4R may be the most versatile sighting device in the Sightron family of scopes.

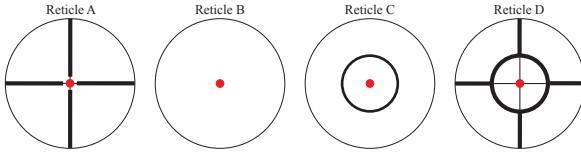

S33-4R/RST Reticles

## S33-MIL

The S33-MIL ESD features four reticle options. NV1 and NV2 are designed for use with Generation 1 and 2 Night Vision Devices. A manual 8 position selector switch provides a wide range of options for all lighting conditions. The Auto Mode allows for automatic adjustment by the internal light system.

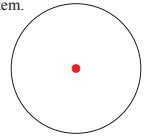

S33-MIL Reticle

## ESD Specifications

Note: 1 MOA is approximately equal to 1" at 100yards, 1/2" at 50 yards and 1/4" at 25 yards.

Item Number	Magnification	Overall Length	Weight	Objective Diameter	Tube Diameter	Dot Size/ Reticle Type	Field of View @100 Yards	Click Value @100 Yards	Battery	Finish
S-30-5	1X	4.75"	5.0 oz.	25mm	30mm	5 MOA	52'	1.0"	CR2032	Matte Black
S33-4R	1X	5.70"	6.3 oz.	27mm	33mm	4 Patterns	76'	1.0"	CR2032	Matte Black
S33-4RST	1X	5.70"	6.3 oz.	27mm	33mm	4 Patterns	76'	1.0"	CR2032	Stainless
S33-MIL	1X	00	00	27mm	33mm	5MOA	00	1.0"	CR2032	Matte Black

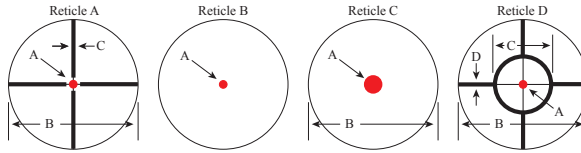

## ESD Reticle Subtensions

Note: All values are in inches.

Item Number	Distance	Reticle A	Reticle B	Reticle C	Reticle D
S30-5	25 yards		1.25		
	50 yards		2.5		
	75 yards		3.75		
	100 yards		5		
S33-4R/RST	25 yards	0.25/30/1.25	1	2/18.75	0.5/30/7.5/2.5
	50 yards	0.5/60/2.50	2	4/37.5	1.0/60/15.0/5.0
	75 yards	0.75/90/3.75	3	6/56.25	1.5/90/22.5/7.5
	100 yards	1.0/120/5	4	8/75	2/120/30/1.0
S33-MIL	25 yards		1.25		
	50 yards		2.5		
	75 yards		3.75		
	100 yards		5		

## Sightron, Inc. Products Limited Warranty

Sightron, Inc., will repair this product or replace the product, at Sightron's sole option, free of charge (except for a \$7.50 handling charge) for two (2) years from the date of original purchase in the event of a defect in material or workmanship. This warranty only covers failures due to defects in materials or workmanship which occur during normal and regular use. It does not cover damage which occurs in shipment or failures which are not supplied by Sightron, Inc., or failures which result from accident, mis-use, abuse, neglect, mishandling, misapplication, alteration, modification or service by anyone other than a Sightron, Inc. factory or authorized service center or damage that is attributable to acts of God.

There are no express warranties except as listed above.

SIGHTRON, INC. SHALL NOT BE LIABLE FOR INCIDENTAL OR CONSEQUENTIAL DAMAGES

RESULTING FROM THE USE OF THIS PRODUCT OR ARISING OUT OF ANY BREACH OF THIS WARRANTY. ALL EXPRESS AND IMPLIED WARRANTIES, INCLUDING THE WARRANTY OF MERCHANTABILITY AND FITNESS FOR A PARTICULAR PURPOSE, ARE LIMITED TO THE APPLICABLE WARRANTY PERIOD SET FORTH ABOVE.

Some states do not allow the exclusion or limitation of incidental or consequential damages, or limitations may not apply to you. This warranty gives you specific legal rights and you may also have other legal rights which vary from state to state. If a problem with this product develops during or after the warranty period, you should contact Sightron, Inc. factory, your dealer or return your product with a brief explanation of the problem you are experiencing. Please include your complete shipping address and your daytime telephone number so we may contact you if necessary.

# SIGHTRON™

100 Jeffrey Way, Suite A, Youngsville, NC 27596

Telephone: 800.867.7512 Fax: 919.562.7129 www.sightron.com Email: info@sightron.com